



THURLESTONE
Bath

Carter Jonas

THURLESTONE, NORTH ROAD, BATH, BA2 6HY

- Bath City Centre 1.5 miles
- Bath University and Leisure Centre 0.25 miles
- London (Paddington) from 90 minutes from Bath Spa Station

Atrium reception hall • Inner hall • Sitting room • Kitchen • Three bedrooms • Two bath/shower rooms (one en suite) • Utility • South facing balcony and gardens • Off street parking for two cars

DESCRIPTION

This impressive lateral apartment with level access provides flexible accommodation with breath-taking elevated views over surrounding countryside.

The property consists of a welcoming entrance hall with an atrium style glazed roof that leads into a spacious hallway that provides additional living space. Off the hallway is a spacious sitting room, having a large bow window at one end and with access onto the south facing balcony that spans the entire length of the property. A well-equipped kitchen with superb views sits between two large double bedrooms, the master bedroom having an en suite shower room. There is a further third bedroom and a family bathroom and a laundry room. One bedroom has direct access to the balcony and is currently used as a breakfast/sitting room. The balcony runs along the rear of the property and faces south westerly with wonderful panoramic views.

To the front of the property is a driveway with ample parking and access to the private garden. This is terraced, with paved and grass areas as well as a patio area to sit and appreciate the view. A chalet and summerhouse provide outdoor storage areas.

A LARGE LATERAL APARTMENT WITH LEVEL ACCESS, PRETTY GARDEN, OFF ROAD PARKING AND BALCONY ENJOYING PICTURESQUE AND PANORAMIC VIEWS OVER THE CITY WITH A SOUTHERLY ASPECT.



LOCATION

The property enjoys a superb elevated position off North Road, approx 1.5 miles from Bath city centre. Bath is a World Heritage City internationally renowned for its Georgian architecture and Roman heritage. There is a frequent bus service with a stop on Bathwick Hill within a short walk. Nearby is National Trust woodland that forms part of the superb Bath Skyline Walk. The University of Bath (with its excellent sporting facilities including indoor tennis courts, well equipped gymnasium and 50m swimming pool) is under a mile away. Bath Golf Club, King Edward's School are all close by, and other excellent schools within easy reach.

ADDITIONAL INFORMATION

Tenure: Leasehold, 966 years remaining.

Services: All mains services are connected.

Local Authority: Bath and North East Somerset Council.

Council Tax Band: F

Directions: The property can be found towards the top of North Road just before Quarry Road on the left. There is restricted parking within the area so please check before leaving your vehicle.



Thurlestone,
North Road,
Bath BA2 6HY
Main House
1294 Sq Ft - 120 Sq M
Outbuilding
28 Sq Ft - 3 Sq M
Total Area
1322 Sq Ft - 123 Sq M

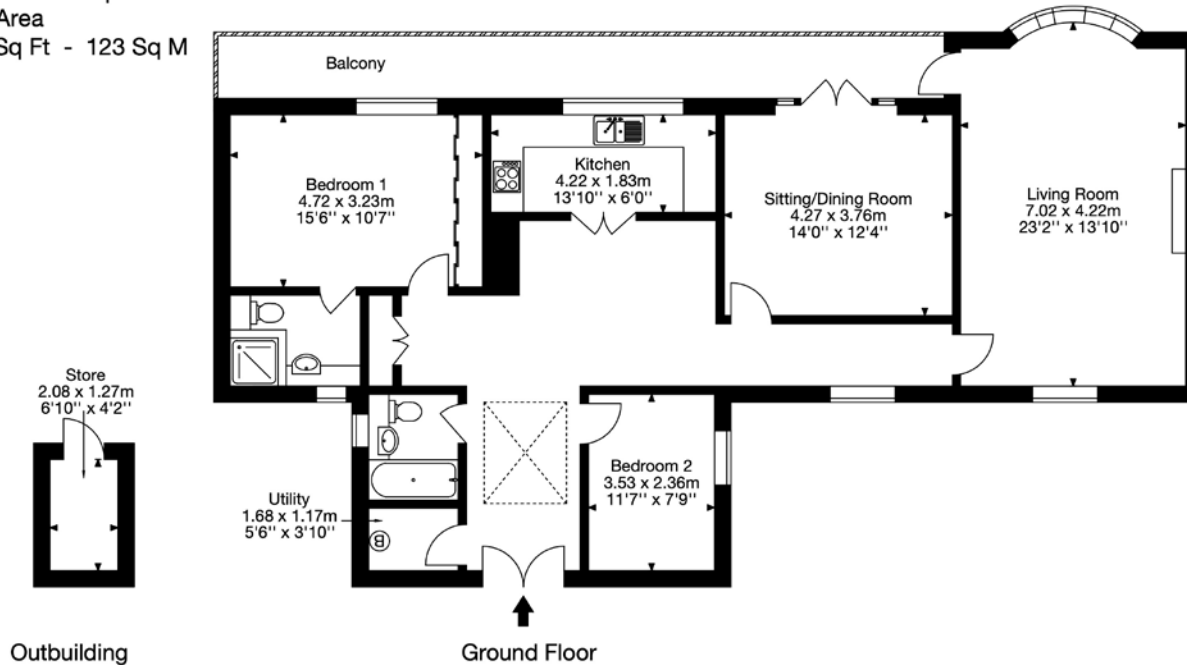
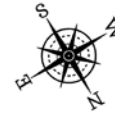

Capture Property Marketing 2022. Drawn to FICIS guidelines.
All Measurements are approximate and should not be relied on as a statement of fact.
Plan is for illustration purposes only. Not drawn to scale.

Capture

Bath 01225 747250

bath@carterjonas.co.uk

5-6 Wood Street, Bath, BA1 2JQ

carterjonas.co.uk

Offices throughout the UK



IMPORTANT INFORMATION

These particulars are for general information purposes only and do not represent an offer of contract or part of one. Carter Jonas has made every attempt to ensure that the particulars and other information provided are as accurate as possible and are not intended to amount to advice on which you should rely as being factually accurate. You should not assume that the property has all necessary planning, building regulations or other consents and Carter Jonas have not tested any services, facilities or equipment. Any measurements and distances given are approximate only. Purchasers must satisfy themselves of all of the aforementioned by independent inspection or otherwise. Although we make reasonable efforts to update our information, neither Carter Jonas LLP nor anyone in its employment or acting on its behalf makes any representations warranties or guarantees, whether express or implied, in relation to the property, or that the content in these particulars is accurate, complete or up to date. Our images only represent part of the property as it appeared at the time they were taken. If you require further information please contact us.