



QUEEN EDITHS WAY, CAMBRIDGE, CB1
£1,495,000

Carter Jonas

QUEEN EDITHS WAY, CAMBRIDGE, CB1

Combining modern architecture with elegant and stylish design, this truly breath-taking home offers accommodation over three floors and benefits from large integral garage, four double bedrooms, four bathrooms and a stunning open-plan kitchen/dining area with high quality kitchen.

Accessed via a sweeping driveway and surrounded by mature trees and stunning landscaping, nestled in a quiet corner of Cambridge. Upon entering this home, you will find a generous entrance hall with oak engineered flooring, double bedroom with en-suite and built in wardrobes, and dedicated utility room with sink, washing machine and tumble dryer.

The staircase to the first floor features oak handrail and glass balustrades and leads to a welcoming open-plan kitchen/dining room, with separate living room featuring bio-ethanol fireplace and sliding doors onto garden. The kitchen has been designed by a local company, and benefits from stone worktops and integrated appliances to include American style fridge/freezer, wine cooler, two slide and hide ovens, eye level microwave, ceramic induction hob with additional gas burner and multi-function tap. With ample natural light encouraged by the floor to ceiling windows and huge skylight. There is also a further double bedroom with en-suite to the first floor, ideal for a guest room or study.

To the second floor is a further double bedroom, as well as the Principal Suite which includes large ensuite bathroom and separate shower and fitted wardrobes.

Outside, there is private parking and beautiful landscaping, with a staircase providing access to the rear garden which has a generous porcelain tile patio.

AMENITIES

- Exclusive and private award-winning development of just four homes
- Leafy views and private garden
- Ready TO MOVE INTO!
- Underfloor heating to ground and first floor
- 550sqft integral garage with EV charging point & underfloor heating
- Stunning oak engineered flooring
- Large open-plan kitchen/dining room
- Living room with Bio-ethanol fireplace
- Smart home ready

ONE OF JUST A FEW HOMES REMAINING ON AN AWARD-WINNING DEVELOPMENT, THIS IMPRESSIVE 4 BEDROOM DETACHED HOUSE HAS BEEN BUILT TO AN EXCEPTIONAL STANDARD WITH LARGE INTEGRAL GARAGE, STUNNING OPEN-PLAN KITCHEN/DINING ROOM AND PRIVATE GARDEN.





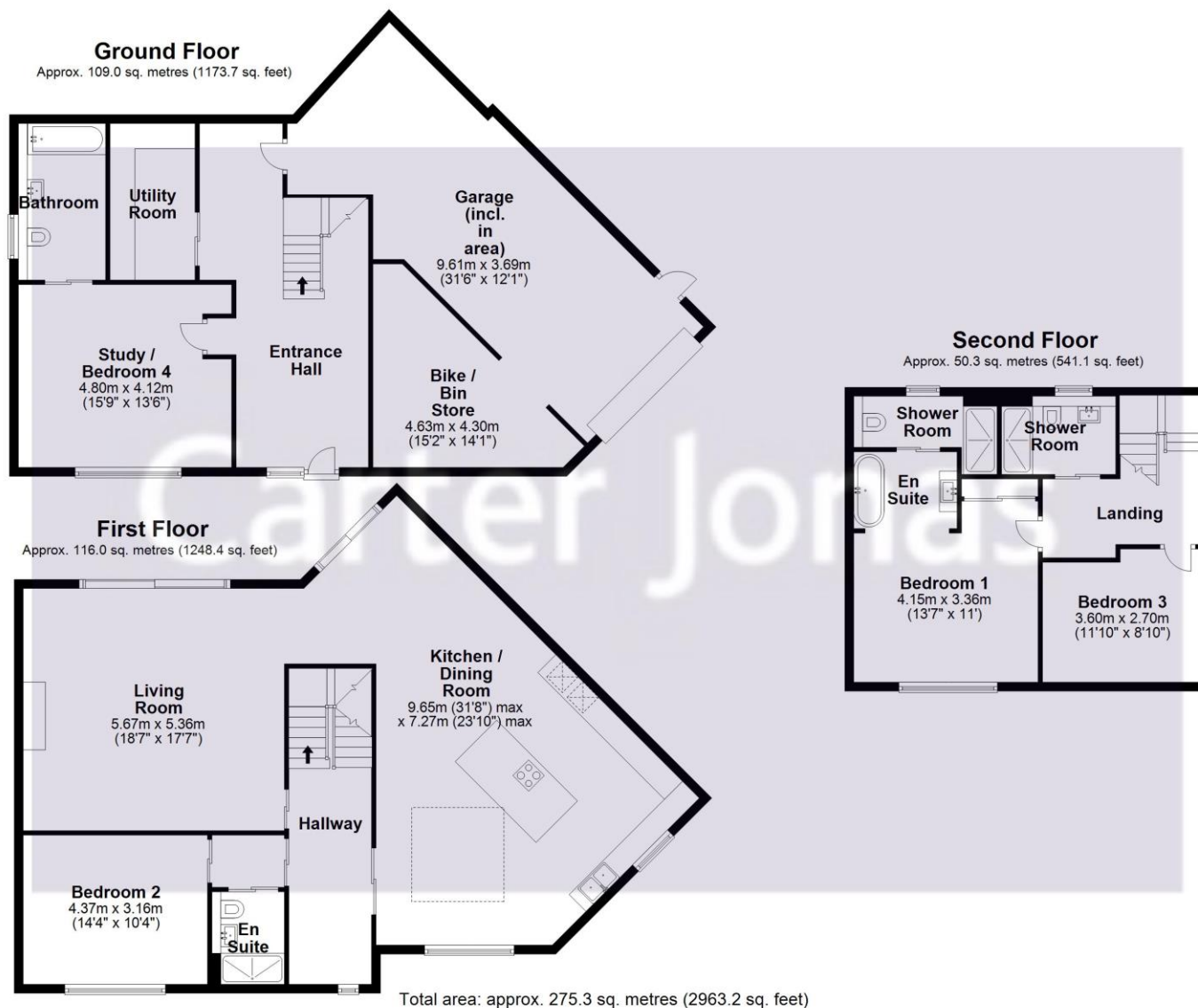

**Building Excellence
AWARDS 2023**
Regional Winner



Cambridge New Homes 01223 403330

cambridge@carterjonas.co.uk
The Marque, 141 Hills Road, Cambridge, CB2 8RJ

carterjonas.co.uk
Offices throughout the UK

Exclusive UK affiliate of
CHRISTIE'S
INTERNATIONAL REAL ESTATE

IMPORTANT INFORMATION

These particulars are for general information purposes only and do not represent an offer of contract or part of one. Carter Jonas has made every attempt to ensure that the particulars and other information provided are as accurate as possible and are not intended to amount to advice on which you should rely as being factually accurate. You should not assume that the property has all necessary planning, building regulations or other consents and Carter Jonas have not tested any services, facilities or equipment. Any measurements and distances given are approximate only. Purchasers must satisfy themselves of all of the aforementioned by independent inspection or otherwise. Although we make reasonable efforts to update our information, neither Carter Jonas LLP nor anyone in its employment or acting on its behalf makes any representations warranties or guarantees, whether express or implied, in relation to the property, or that the content in these particulars is accurate, complete or up to date. Our images only represent part of the property as it appeared at the time they were taken. If you require further information please contact us.

Classification L2 - Business Data