



Land at West Newton

Bridgwater, Somerset

Carter Jonas



# Land at West Newton Bridgwater Somerset TA7 0BZ

## A productive parcel of arable land.

The land at West Newton comprises a single enclosure of gently sloping arable land extending to 10.39 acres.

The land is offered for sale by private treaty with a guide price of £140,000.

### Tenure & Possession

The freehold of the land is offered for sale with vacant possession available upon completion. Access to the land is via a right of access over the neighbouring field to the west.

### Taunton

01823 428 593 | [jack.mitchell@carterjonas.co.uk](mailto:jack.mitchell@carterjonas.co.uk)

Quad 4000, Blackbrook Park Avenue, Taunton, Somerset, TA1 2PX

### Important Information

These particulars are for general information purposes only and do not represent an offer or contract or part of one. Carter Jonas or anyone in their employment has made every attempt to ensure that the particulars and other information provided are as accurate as possible and they are not intended to amount to advice on which you should rely as being factually accurate. Full information which may be relevant to your decision regarding the property can be found on the property listing on [carterjonas.co.uk](http://carterjonas.co.uk) or, (including off market properties) on the brochure or a separately available material information sheet. We would advise you to confirm the details of any material information prior to any offer being submitted. You should not assume that the property has all necessary planning, building regulations or other consents and Carter Jonas has not tested any services, facilities or equipment. Any measurements and distances given are approximate only. Where Carter Jonas has been provided with a floorplan by a third party, we cannot guarantee that the floorplan has been measured in accordance with IPMS. Purchasers must satisfy themselves of all of the aforementioned by independent inspection or otherwise. Our images only represent part of the property as it appeared at the time they were taken and do not represent the furnishings included; these are confirmed in a separate inventory. If you require further information, please contact us.

### Health & Safety

Potential purchasers are requested to take particular care when inspecting the land.

### Local Authority

Somerset Council  
[www.somerset.gov.uk](http://www.somerset.gov.uk)

### Viewings

The land may be viewed during reasonable daylight hours with a set of these sales particulars in hand and after informing the selling agents.

### Directions

Heading from Taunton to North Petherton on the A38, turn right onto Moon Lane signed to West Newton. At the T-Junction, turn right. The land will be found after about 1/3 of a mile on the left opposite the property known as Rydon Cottage.



/// tidy.inventors.unsecured

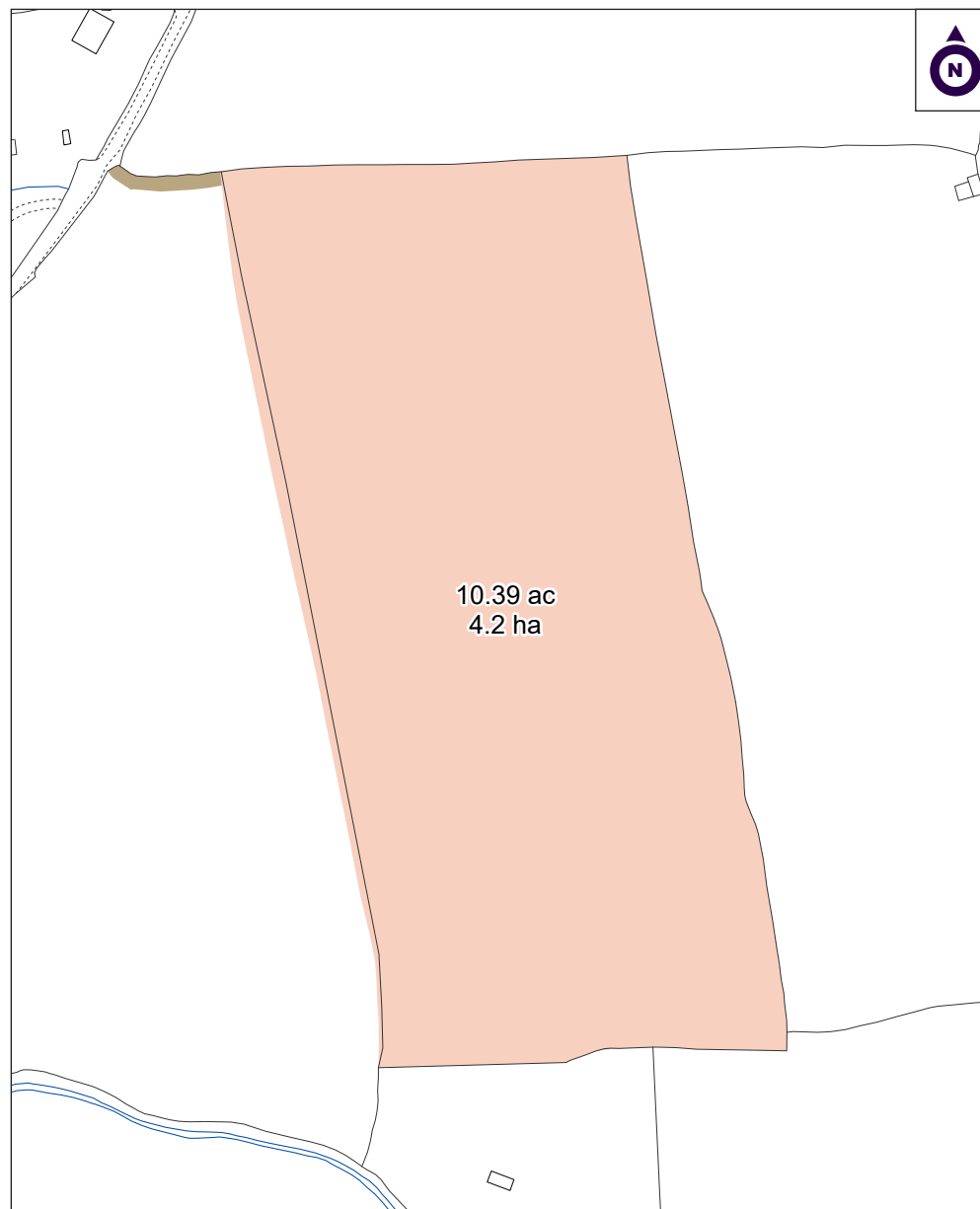

Carter Jonas

Exclusive UK affiliate of  
**CHRISTIE'S**  
INTERNATIONAL REAL ESTATE