



**QUEEN EDITHS WAY, CAMBRIDGE, CB1**  
**£1,650,000**

**Carter Jonas**

# QUEEN EDITHS WAY, CAMBRIDGE. CB1

This individually designed two storey home occupies the corner plot of this stunning development. Nestled in amongst mature trees, and with substantial parking provision.

Upon entry is an impressive entrance hall with ample light flooding in from the skylight upstairs. The soft engineered oak flooring paired with carpets to bedrooms and stairs gives a warm but contemporary feel, and with underfloor heating throughout the entirety of the property there is a real sense of luxury.

The principle bedroom benefits from a dedicated dressing area with fitted wardrobes and an impressive en-suite which has a standalone bath and separate shower behind frosted glass pocket door. Two further bedrooms with generous fitted wardrobes to bedroom 2, plus a further family bathroom with separate bath and shower. There is also a dedicated utility room with sink, washing machine and tumble dryer.

The staircase to the first floor features oak handrail and glass balustrades and leads to a stunning open-plan living space with impressive high ceilings, stunning sky light, bio-ethanol fireplace and Velfac triple glazed sliding doors onto the rear garden. The high-quality kitchen has been designed by a local company and features a large central island with breakfast bar and storage underneath. Integrated appliances include dishwasher, American style fridge/freezer with ice and water dispenser, two slide and hide ovens, combi-oven, ceramic induction hob with additional gas burner, wine fridge and multi-function tap delivering boiling water on demand.

There is also a further double bedroom with en-suite to the first floor, ideal for a guest room or home office.

Outside, there is ample private parking and landscaped front garden, with a staircase providing access to the rear garden which has a generous porcelain tile patio.

## AMENITIES

- Exclusive and private development of just four homes
- Stunning open-plan living area with central bio-ethanol fireplace
- Natural light flooding in through floor to ceiling windows and sky light
- Outstanding specification throughout
- Smart home ready and wiring for solar panels
- Close proximity to Addenbrookes & Bio medical campus
- High specification kitchen by a local designer
- Generous bedrooms with built-in wardrobes to beds 1 & 2
- Built by a local developer
- 10 year warranty

**AN INDIVIDUALLY DESIGNED FOUR BEDROOM HOME ON THIS PRIVATE DEVELOPMENT, NESTLED AMONGST MATURE TREES AND OCCUPYING THE CORNER PLOT, AND WITH A GENEROUS GARDEN TO THE REAR.**



Classification L2 - Business Data





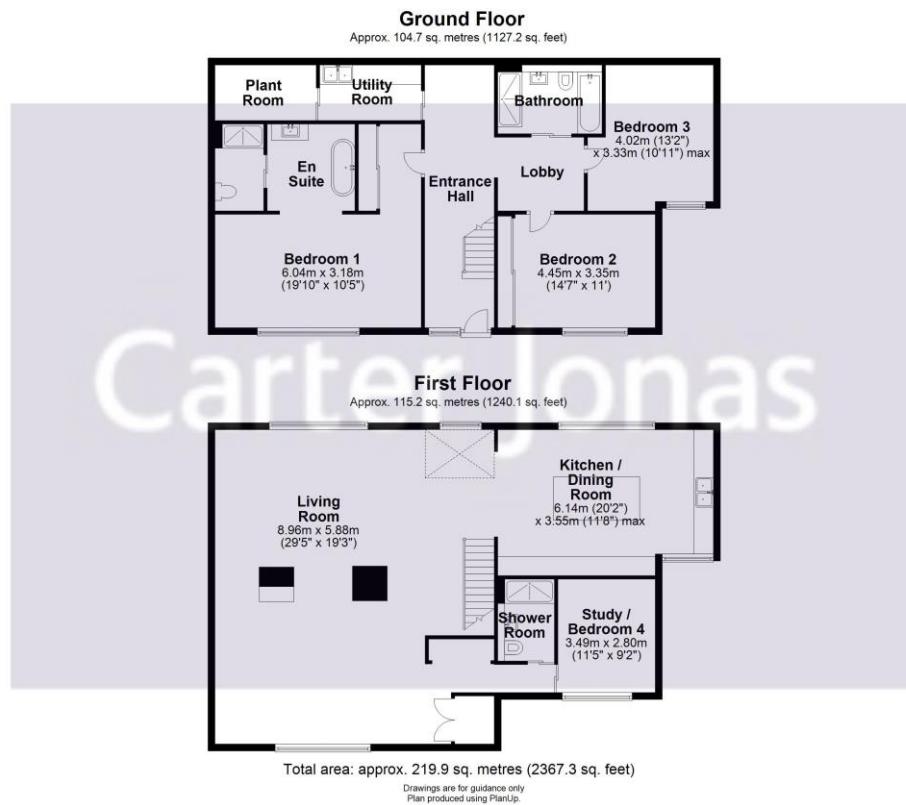

## Cambridge New Homes 01223 403330

cambridge@carterjonas.co.uk  
The Marque, 141 Hills Road, Cambridge, CB2 8RJ

**carterjonas.co.uk**  
Offices throughout the UK

*Exclusive UK affiliate of*

**CHRISTIE'S**  
INTERNATIONAL REAL ESTATE

Classification L2 - Business Data

## IMPORTANT INFORMATION

These particulars are for general information purposes only and do not represent an offer of contract or part of one. Carter Jonas has made every attempt to ensure that the particulars and other information provided are as accurate as possible and are not intended to amount to advice on which you should rely as being factually accurate. You should not assume that the property has all necessary planning, building regulations or other consents and Carter Jonas have not tested any services, facilities or equipment. Any measurements and distances given are approximate only. Purchasers must satisfy themselves of all of the aforementioned by independent inspection or otherwise. Although we make reasonable efforts to update our information, neither Carter Jonas LLP nor anyone in its employment or acting on its behalf makes any representations warranties or guarantees, whether express or implied, in relation to the property, or that the content in these particulars is accurate, complete or up to date. Our images only represent part of the property as it appeared at the time they were taken. If you require further information please contact us.