



MAYTHORN

Wetherden Road, Great Ashfield, Suffolk

Carter Jonas

MAYTHORN, WETHERDEN ROAD, GREAT ASHFIELD, BURY ST EDMUNDS, SUFFOLK, IP31 3HR

Bury St Edmunds – 12 miles

Stowmarket – 6 miles

Ipswich – 16 miles

Cambridge – 38 miles

Original timber frame construction • Extensively renovated in recent years • Wealth of period features • Charming sitting room • Separate dining room • Bespoke fitted kitchen • Three bedrooms • Gardens approaching 1 ½ acres • Delightful summer house • Large garage/workshop • Former stables • Lovely countryside views

DESCRIPTION

Estimated to date back to the late 17th Century and surprisingly not listed, Maythorn is a charming detached three-bedroom cottage of traditional timber frame construction with rendered and colour-washed elevations under a part thatched, part tiled roofline. In recent years Maythorn has been the subject of sympathetic renovation and modernisation resulting in an outstanding home of immense charm and personality, and an internal inspection is unreservedly recommended to appreciate the qualities of the home on offer.

OUTSIDE

Occupying generous grounds extending to approaching 1½ acres, the gardens are an outstanding feature of Maythorn with extensive lawns, a multitude of mature trees and wildflower area. A paved south facing terrace abuts the rear of the cottage providing a wonderful alfresco dining area, and with no adjacent neighbours, the gardens provide a fabulous degree of privacy and seclusion.

AN ENCHANTING UNLISTED 17TH CENTURY DETACHED COTTAGE IN WONDERFUL GROUNDS APPROACHING HALF AN ACRE IN A LOVELY RURAL SETTING WITH NO ADJACENT NEIGHBOURS.



OUTSIDE (CONT)

The driveway provides ample parking and leads to a large garage/workshop with power and light connected. There is a purpose-built summer house with fitted log burning stove and a former stable block provides excellent secure storage.

LOCATION

Recorded in the Domesday Book of 1066 as 'Eascefelda' (open land where ash trees grow), Gt Ashfield is a widespread rural village located ten miles east of the historic cathedral town of Bury St Edmunds which provides a comprehensive range of schooling, shopping, recreational and cultural facilities. The nearby villages of Elmswell and Badwell Ash offer everyday amenities and the market town of Stowmarket provides a mainline rail link to London's Liverpool Street station.

ADDITIONAL INFORMATION

Tenure: Freehold

Services: Mains water & electricity connected. Drainage via private system. Oil fired central heating.

Local Authority: Mid Suffolk - Band E

What3Words: ///ratty.punters.cheerful

***Agents Note:** At the time of the preparation of these details, minor finishing works were ongoing following replacement of the windows and general renovation.



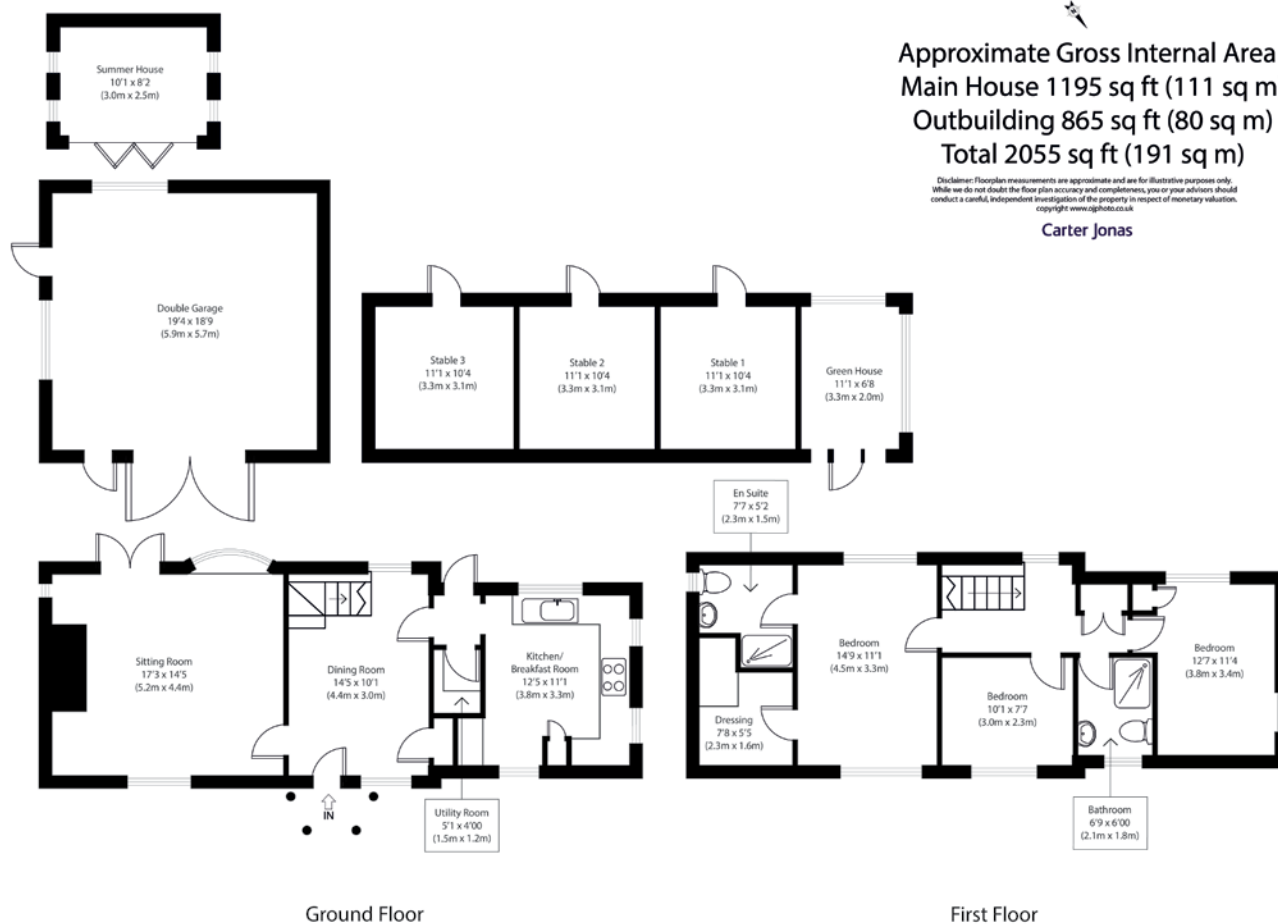

Long Melford 01787 882881

suffolk@carterjonas.co.uk

Little St Mary's, Long Melford, CO10 9LQ

carterjonas.co.uk

Offices throughout the UK

Exclusive UK affiliate of

CHRISTIE'S
 INTERNATIONAL REAL ESTATE

IMPORTANT INFORMATION

These particulars are for general information purposes only and do not represent an offer of contract or part of one. Carter Jonas has made every attempt to ensure that the particulars and other information provided are as accurate as possible and are not intended to amount to advice on which you should rely as being factually accurate. You should not assume that the property has all necessary planning, building regulations or other consents and Carter Jonas have not tested any services, facilities or equipment. Any measurements and distances given are approximate only. Purchasers must satisfy themselves of all of the aforementioned by independent inspection or otherwise. Although we make reasonable efforts to update our information, neither Carter Jonas LLP nor anyone in its employment or acting on its behalf makes any representations warranties or guarantees, whether express or implied, in relation to the property, or that the content in these particulars is accurate, complete or up to date. Our images only represent part of the property as it appeared at the time they were taken. If you require further information please contact us.