



**HILL STREET, MAYFAIR, W1J**  
£650 per week\*

**Carter Jonas**

# FLAT 23, HILL STREET, MAYFAIR, LONDON, W1J

A studio apartment of 261 square feet.

- Furnished
- Studio Room
- Kitchen
- Bathroom

## THE PROPERTY

Situated on the second floor of a refurbished purpose-built block with lift and porter located within walking distance of Berkeley Square, Hyde Park, shopping facilities and transport links the apartment has been neutrally decorated and finished in a modern style.

Mayfair is London's most fashionable destination. With London's finest buildings, largest concentration of luxury hotels, best restaurants, bars, shopping, open spaces and hidden treasures all nestled together in a beautiful village setting.

Nearest Tube: Green Park

AST

The deposit will be £3,250 at a rental value of £650 asking price).

Holding deposit = 1 weeks rent of £650

Deposit is 5 weeks rent (£650 pw = £3,250 deposit)

Council Tax Band E

Electric storage heaters

Community scheme hot water

Ultrafast broadband and mobile coverage available



## ADDITIONAL INFORMATION

Offers Available for a minimum term of 12 months longer terms will be considered

Viewing Strictly by appointment

Local Authority Westminster City Council - Council Tax Band E

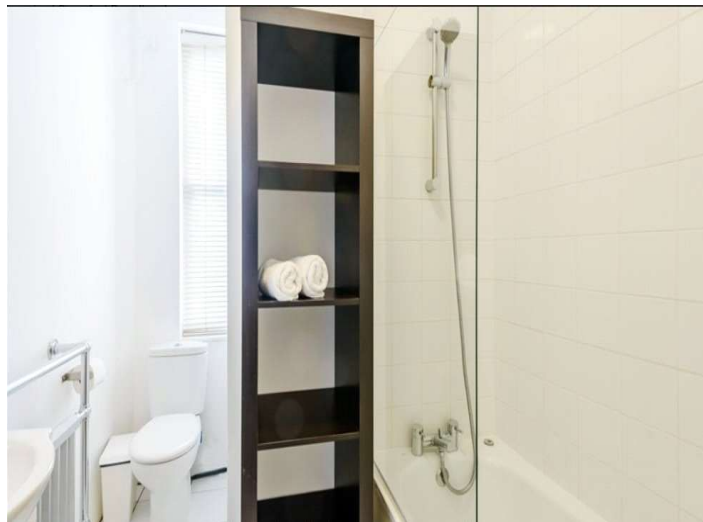

# FLAT 23, 39 HILL STREET, W1

APPROX. GROSS INTERNAL AREA \*  
261 Ft<sup>2</sup> - 24.25 M<sup>2</sup>

ILLUSTRATION FOR IDENTIFICATION PURPOSES ONLY. NOT TO SCALE  
\* As Defined by RICS - Code of Measuring Practice

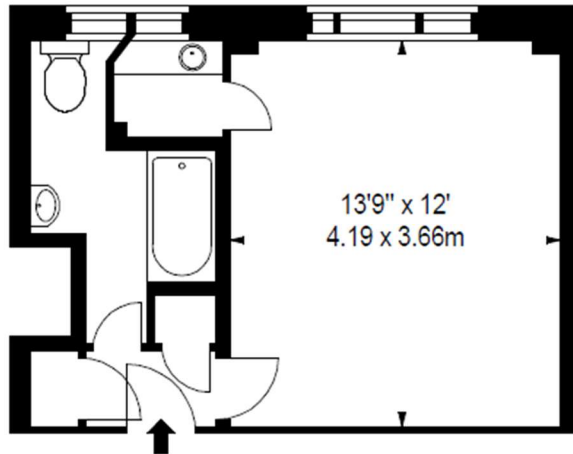

SECOND FLOOR

**BKR**

[www.bkrfloorplans.co.uk](http://www.bkrfloorplans.co.uk)  
T: 0845 257 2023  
© BKR 2011

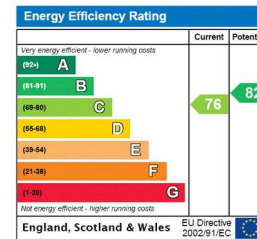

T: 020 7493 0676

18 Davies Street, Mayfair, London, W1K 3DS

E: [mayfair.lettings@carterjonas.co.uk](mailto:mayfair.lettings@carterjonas.co.uk)



Exclusive UK affiliate of

**CHRISTIE'S**  
INTERNATIONAL REAL ESTATE

### IMPORTANT INFORMATION

These particulars are for general information purposes only and do not represent an offer or contract or part of one. Carter Jonas or anyone in their employment has made every attempt to ensure that the particulars and other information provided are as accurate as possible and they are not intended to amount to advice on which you should rely as being factually accurate. Full information which may be relevant to your decision regarding the property can be found on the property listing on [carterjonas.co.uk](http://carterjonas.co.uk) or a separately available material information sheet, and we would advise you to confirm the details of any material information prior to any offer being submitted. You should not assume that the property has all necessary planning, building regulations or other consents and Carter Jonas has not tested any services, facilities, or equipment. Any measurements and distances given are approximate only. Where Carter Jonas has been provided with a floorplan by a third party, we cannot guarantee that the floorplan has been measured in accordance with IPMS. Purchasers or prospective tenants must satisfy themselves of all of the aforementioned by independent inspection or otherwise. Our images only represent part of the property as it appeared at the time they were taken and do not represent the furnishings included; these are confirmed in a separate inventory. If you require further information, please contact us. \*Administration fees may apply depending on tenancy type. Please contact your local branch for this information.