



WILLOW LODGE, STEVENAGE ROAD, SW6
£2,750 per month*

Carter Jonas

WILLOW LODGE, STEVENAGE ROAD, SW6 6NW

- Two bedrooms
- Outside space
- Lift
- Second floor
- River views
- Concierge
- Secure private parking inclusive
- Close to Nuffield Leisure Centre

LOCATION

Willow Lodge is part of the River Gardens development. The development has a fob entry system, a swimming pool (which currently is not in use), communal gardens and an easily accessible pedestrian path which runs along the river and connects to Hammersmith. River Gardens is next to Nuffield Leisure Centre, Londis (on Kenyon Street) and a short walk to the bus stop which connects to the multiple transport links to Central London.

THE PROPERTY

This gorgeous two bedroom, two bathroom flat has been recently renovated and it has direct river views and a balcony. Storage is extremely generous and the reception is very spacious.

There is a fully fitted kitchen with a washing machine & dishwasher and once again, benefits from plenty of cupboards and storage. Banham Alarm can be activated at a separate cost however the development has concierge and excellent security. Private parking in a secure car park within the development is inclusive of the rent.

Holding deposit is 1 weeks rent £576.92

Deposit is 5 weeks rent (£576.92pw = £2,884.61 deposit)

Minimum term: 12 months

Council Tax Band G

**A spectacular two bedroom apartment in the popular purpose built block of the River Gardens development. The property has river views.
EPC rating C**



OUTSIDE

Balcony

ADDITIONAL INFORMATION

Offers	Available for a minimum term of 12 months longer terms will be considered
Viewing	Strictly by appointment
Local Authority	Hammersmith & Fulham



Key :
CH - Ceiling Height

Willow Lodge, SW6

Approximate Area = 91.23 sq m / 982 sq ft

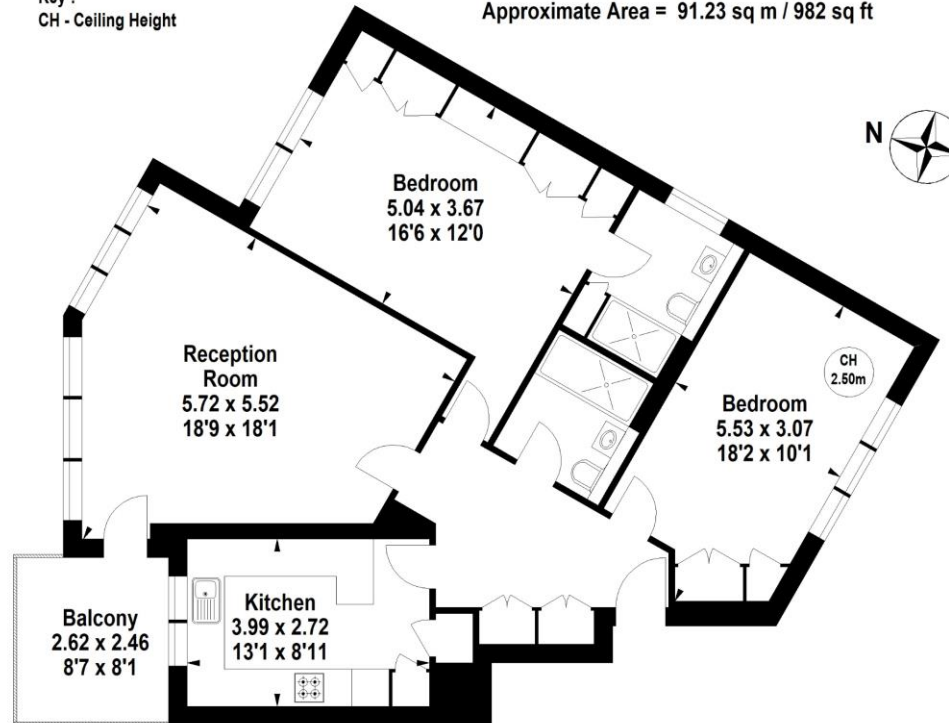

Second Floor

Illustration For Identification Purposes Only.
All measurements and areas are approximate, not to scale.

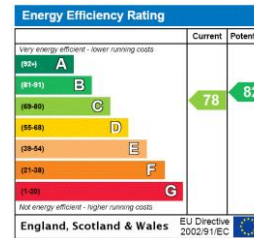

T: 020 7751 8898

361 Fulham Palace Road, London, SW6 6TA

E: parsonsgreen.residential.lettings@carterjonas.co.uk

carterjonas.co.uk

Offices throughout the UK



Classification L2 - Business Data

IMPORTANT INFORMATION

Our property particulars do not represent an offer or contract, or part of one. The information given is without responsibility on the part of the agents, seller(s) or lessor(s) and you should not rely on the information as being factually accurate about the property, its condition or its value. Neither Carter Jonas LLP nor anyone in its employment or acting on its behalf has authority to make any representation or warranty in relation to this property. We have not carried out a detailed survey, nor tested the services, appliances or fittings at the property. The images shown may only represent part of the property and are as they appeared at the time of being photographed. The areas, measurements and distances are approximate only. Any reference to alterations or use does not mean that any necessary planning permission, building regulation or other consent has been obtained. The VAT position relating to the property may change without notice. Administration fees may apply depending on tenancy type. Please contact your local branch for this information.