



Land and former Abattoir at Comeytrowe Lane

TAUNTON, SOMERSET

Carter Jonas

LAND AND FORMER
ABATTOIR AT
COMEYTROWE LANE
TAUNTON
SOMERSET
TA4 1EF

Residential development
opportunity on the edge
of Taunton.

Located 2 miles to Taunton town
centre adjoining the Comeytrowe
housing development. 23.67 acres
including 3.07 acres of former abattoir
and 20.6 acres of agricultural land.
Sold for its existing use with residential
development potential.

The site adjoins the new Comeytrowe
housing scheme which has been allocated
for 2,000 houses plus a primary
school. Current developers are a
consortium of house builders including
Taylor Wimpey, Bovis Homes and
Summerfield Developments. Located
between the A38 at Wellington Road,
Rumwell through to Honiton Road in Trull.

The Comeytrowe development has
been started in 2020 for its first phase
of 70 houses.

Carter Jonas

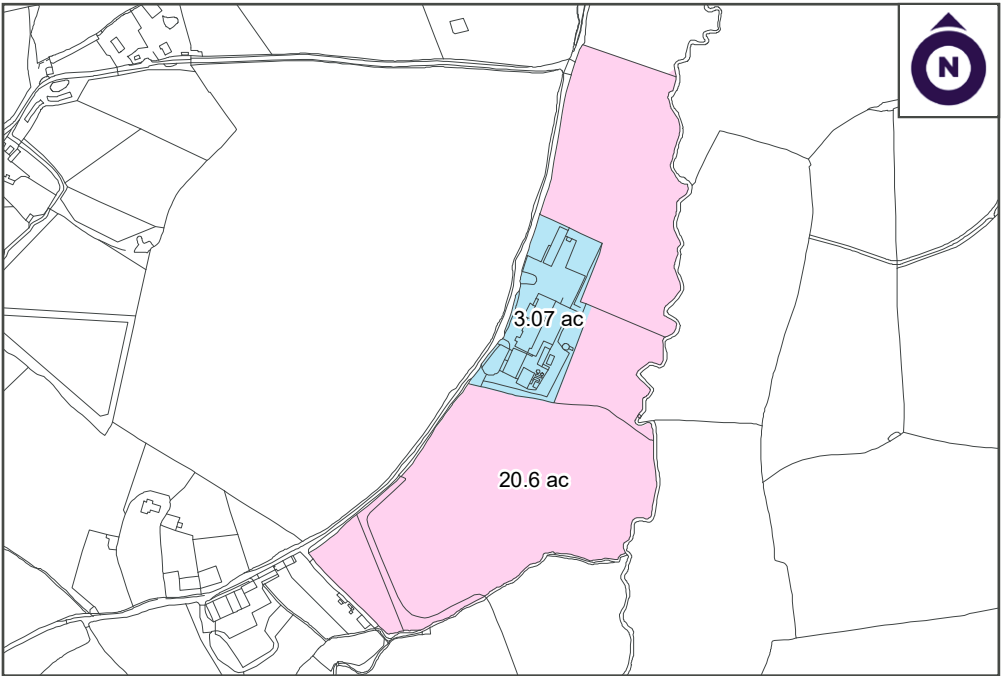

LOCATION

The former abattoir is located just off Comeytrowe Lane, approximately 0.5 miles from the Wellington Road with the town centre being 2 miles away.

Taunton is the county town of Somerset with a range of shops, theatre, cinema, hospital, primary and secondary schools along with the independent schools of Kings, Queens and Taunton School. Taunton is also home to the Somerset Cricket Club.

Taunton has direct access onto the M5 motorway at J25 (6 miles away) as well as Wellington at J26 (5 miles).

The current population of Taunton is approximately 60,479 according to the 2011 census and has easy access to the Devon and West Somerset coastlines.

THE SITE

The site extends to 23.67 acres including 3.07 acres of former abattoir with industrial use with surrounding agricultural land of 20.6 acres with the potential for residential development.

The land is predominantly level and has views over the Blackdown Hills and the surrounding countryside.

METHOD OF SALE

Private treaty.

TENURE & POSSESSION

The freehold interest is being offered for sale at a guide price of £1.65 million.

RIGHTS OF WAY

It should be noted that there is a footpath across the Eastern boundary.

LOCAL AUTHORITIES

Somerset West and Taunton
Deane House
Belverdere Road
Taunton
TA1 1HE
www.somersetwestandtaunton.gov.uk

VIEWINGS

Strictly by appointment with agents
Carter Jonas.



///rocks.sheets.intruding

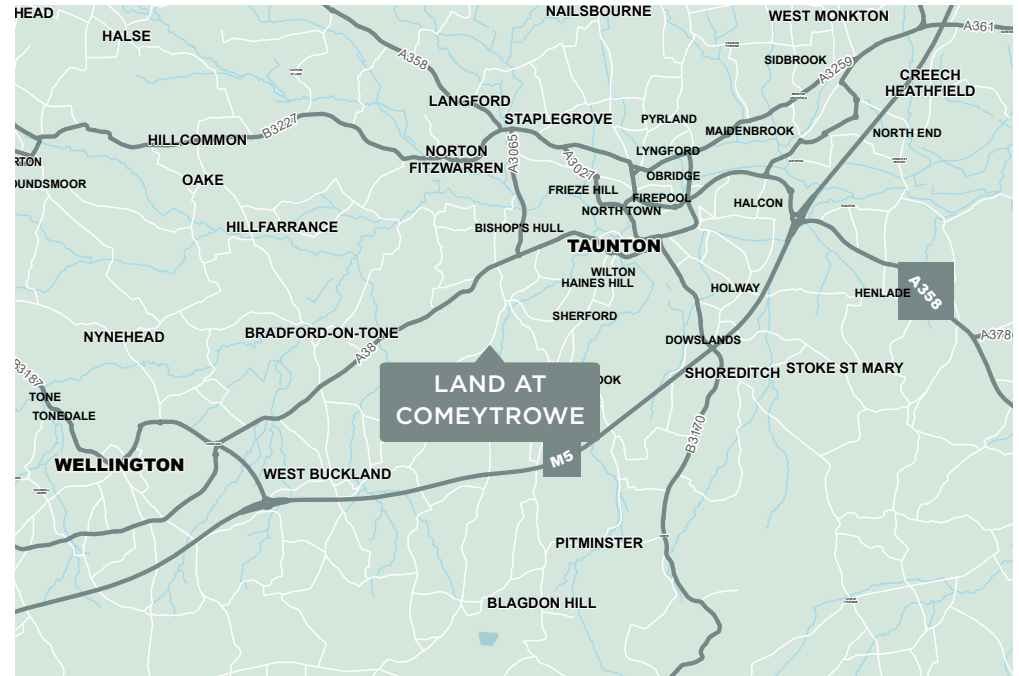

TAUNTON

07717 727 274 | david.hebditch@carterjonas.co.uk
07968 216 596 | stephen.richards@carterjonas.co.uk
Quad 4000, Blackbrook Park Avenue, Taunton, Somerset, TA1 2PX

IMPORTANT INFORMATION

These particulars are for general information purposes only and do not represent an offer of contract or part of one. Carter Jonas has made every attempt to ensure that the particulars and other information provided are as accurate as possible and are not intended to amount to advice on which you should rely as being factually accurate. You should not assume that the property has all necessary planning, building regulations or other consents and Carter Jonas have not tested any services, facilities or equipment. Any measurements and distances given are approximate only. Purchasers must satisfy themselves of all of the aforementioned by independent inspection or otherwise. Although we make reasonable efforts to update our information, neither Carter Jonas LLP nor anyone in its employment or acting on its behalf makes any representations warranties or guarantees, whether express or implied, in relation to the property, or that the content in these particulars is accurate, complete or up to date. Our images only represent part of the property as it appeared at the time they were taken. If you require further information please contact us.



carterjonas.co.uk
Offices throughout the UK

Carter Jonas