



**ATHELSTAN ROAD, WINCHESTER, SO23**  
£2,500 per month\*

**Carter Jonas**



# **ATHELSTAN ROAD, WINCHESTER, HAMPSHIRE, SO23 7GA**

- 4 Bedrooms
- 2 Reception Rooms
- 3 Bathrooms
- Unfurnished
- Town House
- Garden & Parking
- Parking

## **THE PROPERTY**

Situated in a popular location the house is in the catchment area of St Bede's CofE Primary School, The Westgate All Through School and Peter Symonds Sixth Form College.

The house is entered on the ground floor and the entrance hall gives access to the hall with stairs rising to the first floor and a door into the kitchen. The kitchen is well fitted with white eye and base level units and there is space for a good sized table. There is a useful cupboard housing the washing machine and glazed windows to the sitting room below. The sitting room is set down from the kitchen with high ceilings and has French windows to the garden. There is a useful storage area under the kitchen.

The first floor has two double bedrooms, one to the rear with a balcony and one to the front, a further study and a contemporary shower room. The principal bedroom with en suite shower room is on the top floor, there is another double bedroom and the family bathroom with a shower over the bath.

There is a small garden to the rear of the property with parking for one car and an all-weather grass area. There is further unrestricted parking to front and rear.

## **OUTSIDE**

There is a small garden to the rear of the property with parking for one car and an all-weather grass area. There is further unrestricted parking to front.

A sophisticated town house offering spacious and contemporary accommodation within an easy walk of the railway station, a wealth of shops, restaurants, cinema & theatre as well as the Cathedral and museums in the city centre. The M3, A33 & A34 are a short drive away.





Holding deposit equivalent to 1 week's rent = £576  
Deposit is 5 weeks rent (£2,500 pcm = £2,884 deposit)

ADDITIONAL INFORMATION

Offers	Available for a minimum term of 12 months longer terms will be considered
Viewing	Strictly by appointment
Local Authority	Winchester City Council - Council Tax Band D
Directions	From the train station follow the Andover Road passing the Esso garage on your right, Athelstan Road is the next turning on the right and no 8 is found almost at the end on the right hand side.

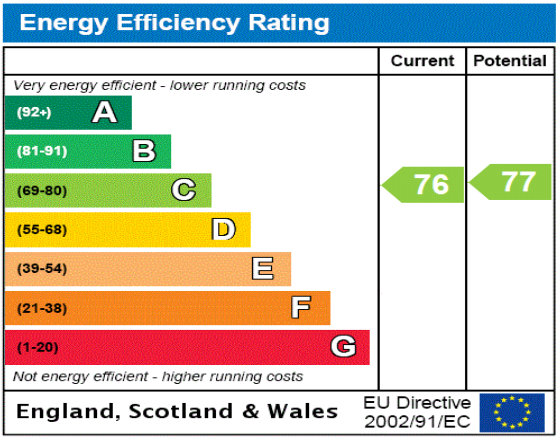

# Athelstan Road, Winchester, SO23

Approximate Gross Internal Area  
137.8 sq m / 1483 sq ft

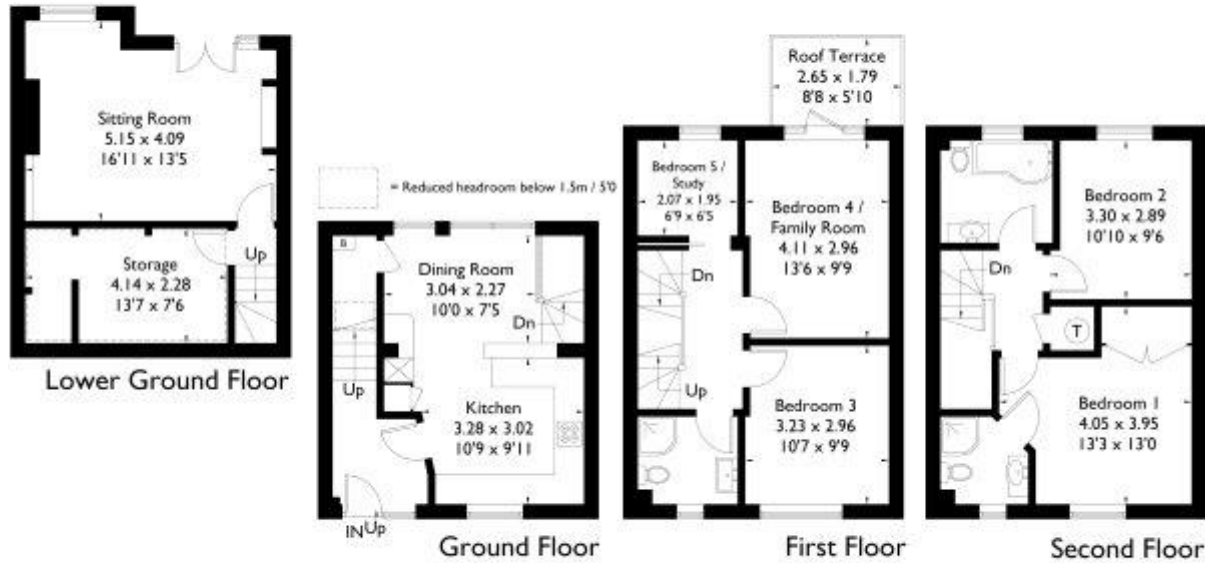

FLOORPLANZ © 2018 0203 9056099 Ref: 207089

This plan is for layout guidance only. Drawn in accordance with RICS guidelines. Not drawn to scale unless stated. Windows & door openings are approximate. Whilst every care is taken in the preparation of this plan, please check all dimensions, shapes & compass bearings before making any decisions reliant upon them.



**T: 01962 876838**

9-10 Jewry Street, Winchester, Hampshire, SO23 8RZ

E: [winchester-residentiallettings@carterjonas.co.uk](mailto:winchester-residentiallettings@carterjonas.co.uk)

**[carterjonas.co.uk](http://carterjonas.co.uk)**

Offices throughout the UK



Classification L2 - Business Data

## IMPORTANT INFORMATION

Our property particulars do not represent an offer or contract, or part of one. The information given is without responsibility on the part of the agents, seller(s) or lessor(s) and you should not rely on the information as being factually accurate about the property, its condition or its value. Neither Carter Jonas LLP nor anyone in its employment or acting on its behalf has authority to make any representation or warranty in relation to this property. We have not carried out a detailed survey, nor tested the services, appliances or fittings at the property. The images shown may only represent part of the property and are as they appeared at the time of being photographed. The areas, measurements and distances are approximate only. Any reference to alterations or use does not mean that any necessary planning permission, building regulation or other consent has been obtained. The VAT position relating to the property may change without notice. Administration fees may apply depending on tenancy type. Please contact your local branch for this information.