



22 FOSS PLACE, YORK
£175,000

Carter Jonas

FOSS ISLANDS ROAD, YORK, YO31 7AF

Located in the recently developed Foss Place, this one-bedroom upper floor apartment is beautifully presented throughout and benefits from an allocated parking space. Placed just moments away from the heart of the city centre the property also has easy access to the railway station.

The property is entered via a communal entrance hall with secure keypad entry, which has a lift and staircase to all floors.

The front door of the apartment opens into a hallway giving access to the main living area with a fabulous open plan layout, a good-sized double bedroom and shower room

The living area offers space for both lounge and dining furniture and is open to a stylish modern kitchen with integrated hob, oven, fridge, microwave and washing machine.

The apartment would make a superb investment opportunity or an ideal first-time home enjoying the benefit of quality fixtures and fittings, modern electric heating and external bike storage.

It is situated in a quiet area minutes from the City Centre and close to a variety of supermarkets and local amenities.

Viewing is essential to appreciate the accommodation and location on offer.

York offers excellent national and international connectivity; London and Edinburgh are served by an average of 40 trains daily and travel times between 1 hour 50 minutes to London King's Cross and just over 2 hours to Edinburgh.

Whilst embracing its history the city benefits from a thriving cafe culture with an array of artisan and well-known bars and restaurants, excellent shopping and diverse culture with several theatres, an impressive art gallery and a world class racecourse together with excellent schooling/educational facilities

- length of lease 250 years from 2016
- ground rent £300 p.a.
- service charge £1,150 p.a.
- EPC D

CONTEMPORARY ONE BEDROOM CITY APARTMENT WITH ALLOCTAED PARKING SPACE WITHIN WALKING DISTANCE OF YORK CITY CENTRE. NO ONWARD CHAIN





GROUND FLOOR
289 sq.ft. (26.8 sq.m.) approx.

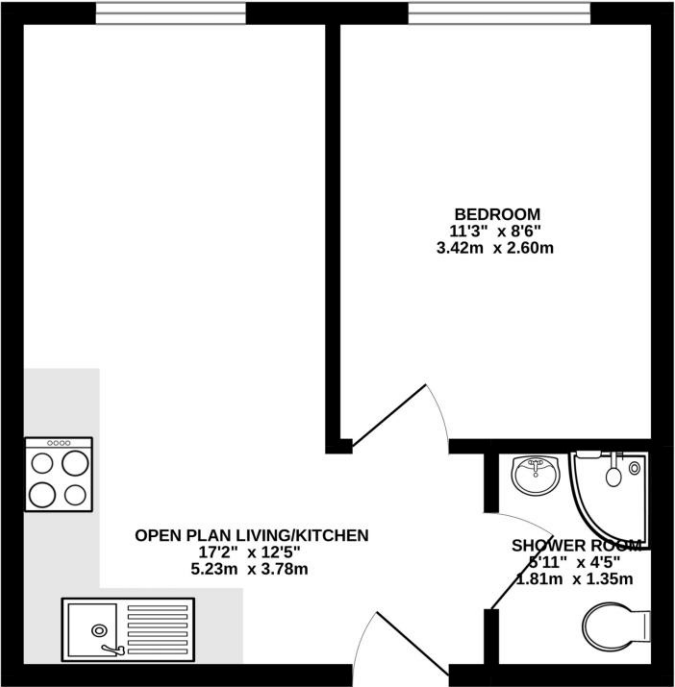

TOTAL FLOOR AREA : 289 sq.ft. (26.8 sq.m.) approx.
Whilst every attempt has been made to ensure the accuracy of the floorplan contained here, measurements of doors, windows, rooms and any other items are approximate and no responsibility is taken for any error, omission or mis-statement. This plan is for illustrative purposes only and should be used as such by any prospective purchaser. The services, systems and appliances shown have not been tested and no guarantee as to their operability or efficiency can be given.
Made with Metropix ©2022

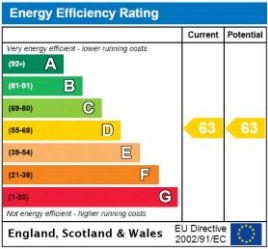

York 01904 558200

york@carterjonas.co.uk
82 Micklegate, York, YO1 6LF

carterjonas.co.uk
Offices throughout the UK

IMPORTANT INFORMATION

These particulars are for general information purposes only and do not represent an offer of contract or part of one. Carter Jonas has made every attempt to ensure that the particulars and other information provided are as accurate as possible and are not intended to amount to advice on which you should rely as being factually accurate. You should not assume that the property has all necessary planning, building regulations or other consents and Carter Jonas have not tested any services, facilities or equipment. Any measurements and distances given are approximate only. Purchasers must satisfy themselves of all of the aforementioned by independent inspection or otherwise. Although we make reasonable efforts to update our information, neither Carter Jonas LLP nor anyone in its employment or acting on its behalf makes any representations warranties or guarantees, whether express or implied, in relation to the property, or that the content in these particulars is accurate, complete or up to date. Our images only represent part of the property as it appeared at the time they were taken. If you require further information please contact us.

Classification L2 - Business Data