



PAVILION ROW, MAIN STREET, FULFORD
£575,000

Carter Jonas

PAVILION ROW, MAIN STREET, YO10 4LJ

A beautifully presented 4 bedroom town house with a south facing courtyard and secure parking, situated in the popular suburb of Fulford, close to York.

Pavilion Row is a fine example of a modern townhouse built in the traditional style, boasting a prominent position within this prime location.

Arranged over three floors, this elegant property offers well-designed living spaces to suit modern lifestyles. The ground floor comprises an inviting entrance hall, a convenient WC, a study, a spacious kitchen/breakfast room, a utility room, and a delightful garden room, seamlessly blending indoor and outdoor living spaces.

Ascending to the first floor, you'll find the luxurious main bedroom suite, complete with an en-suite bathroom, and a versatile living room or potential fifth bedroom, providing flexibility to accommodate your family's needs. The second floor offers three additional well-proportioned bedrooms and a family bathroom, ensuring ample space for everyone.

Externally, this beautiful townhouse welcomes you with an inviting courtyard, while the secure gated parking area to the rear offers peace of mind and convenience.

Fulford is an extremely popular suburb, situated less than a mile South from York city centre, offering a wealth of local amenities. The area is renowned for its excellent secondary school and proximity to the university, making it a favoured choice among commuter families, with the outer ring road/A64 providing easy access.

With its impressive blend of traditional elegance and modern comforts, coupled with an enviable location in the heart of Fulford, Pavilion Row presents an exceptional opportunity for those seeking a truly desirable family home in one of York's most sought-after neighbourhoods.

TENURE Freehold

LOCAL AUTHORITY City of York Council

EPC BAND B COUNCIL TAX BAND F

A BEAUTIFULLY PRESENTED 4 BEDROOM TOWN HOUSE WITH A SOUTH FACING COURTYARD AND SECURE PARKING, SITUATED IN THE POPULAR SUBURB OF FULFORD, CLOSE TO YORK.





Classification L2 - Business Data



Classification L2 - Business Data

GROUND FLOOR
536 sq.ft. (49.8 sq.m.) approx.



1ST FLOOR
535 sq.ft. (49.7 sq.m.) approx.

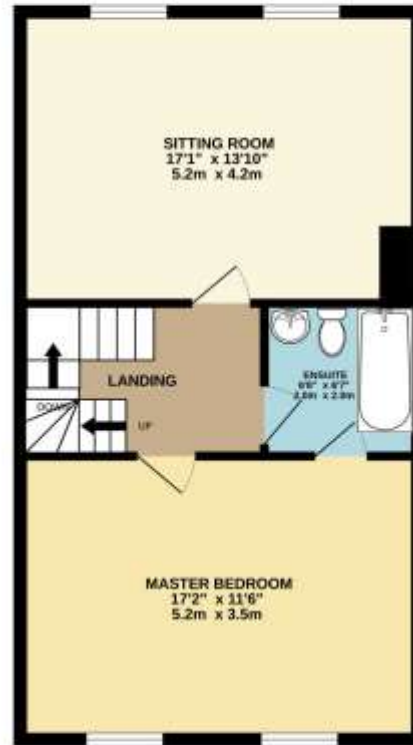

2ND FLOOR
530 sq.ft. (49.2 sq.m.) approx.

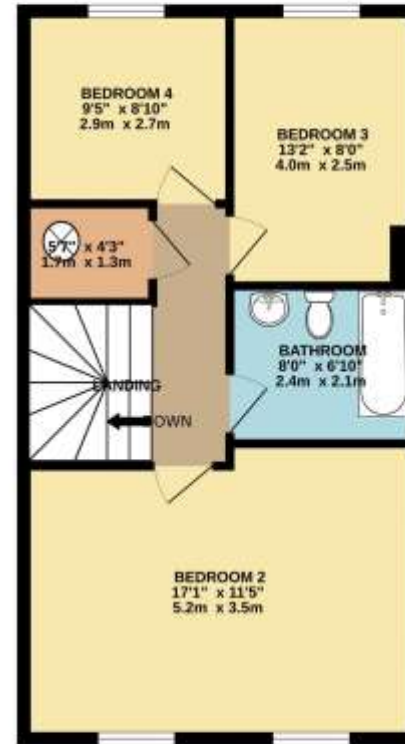

TOTAL FLOOR AREA: 1600 sq.ft. (148.7 sq.m.) approx.

Whilst every attempt has been made to ensure the accuracy of the floorplan contained here, measurements of doors, windows, rooms and any other items are approximate and no responsibility is taken for any error, omission or mis-statement. This plan is for illustrative purposes only and should be used as such by any prospective purchaser. The services, systems and appliances shown have not been tested and no guarantee as to their operability or efficiency can be given.
Made with Metropix i52024

York 01904 558200

york@carterjonas.co.uk
82 Micklegate, York, YO1 6LF

carterjonas.co.uk
Offices throughout the UK

Exclusive UK affiliate of
CHRISTIE'S
INTERNATIONAL REAL ESTATE

Classification L2 - Business Data

IMPORTANT INFORMATION

These particulars are for general information purposes only and do not represent an offer of contract or part of one. Carter Jonas has made every attempt to ensure that the particulars and other information provided are as accurate as possible and are not intended to amount to advice on which you should rely as being factually accurate. You should not assume that the property has all necessary planning, building regulations or other consents and Carter Jonas have not tested any services, facilities or equipment. Any measurements and distances given are approximate only. Purchasers must satisfy themselves of all of the aforementioned by independent inspection or otherwise. Although we make reasonable efforts to update our information, neither Carter Jonas LLP nor anyone in its employment or acting on its behalf makes any representations warranties or guarantees, whether express or implied, in relation to the property, or that the content in these particulars is accurate, complete or up to date. Our images only represent part of the property as it appeared at the time they were taken. If you require further information please contact us.